



pearson
ferrier®



2A BURRS CLOSE
Bury, BL8 1JU
Offers Over £375,000

2A BURRS CLOSE

Property at a glance

- UNIQUE DETACHED PROPERTY
- THREE FITTED BEDROOMS
- OPEN PLAN LOUNGE/KITCHEN/DINER (Over 31ft)
- IMMACULATE CONDITION THROUGHOUT
- VIEW ESSENTIAL
- CLOSE TO BURRS COUNTRYPARK
- EXCELLENT TRANSPORT LINKS

An immaculately presented three bedroom detached property located on Burrs Close just off Brandlesholme Road. The location offers excellent access and transport links to Bury & Ramsbottom centres, with local primary schools, handy parade of shops and Burrs Country Park and the Kirklees nature trail being on your doorstep. The property is a true credit to the current owners and really must be viewed to appreciate the accommodation on offer. In brief the property comprises of: Vestibule, open plan lounge/kitchen/diner (being over 31ft), and guest w.c. To the first floor is a landing with built in storage, three fitted bedrooms and contemporary family bathroom. There is a low maintenance garden to the side and integral garage. The property is ideal for growing families and those looking to downsize.

Leasehold - 990 years from 28 March 1935

EPC-C

Council Tax Band - C



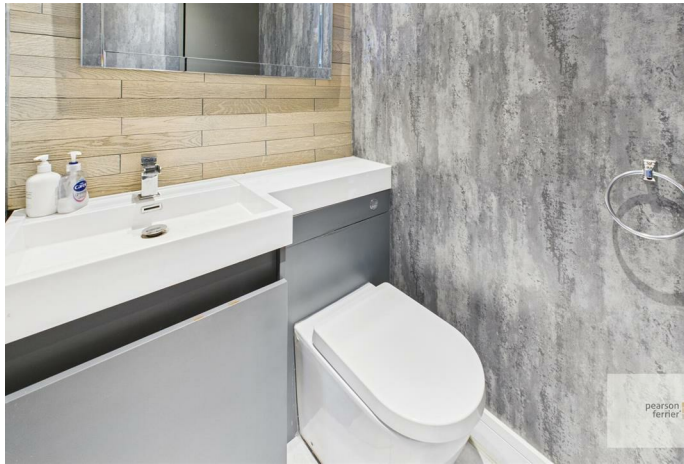

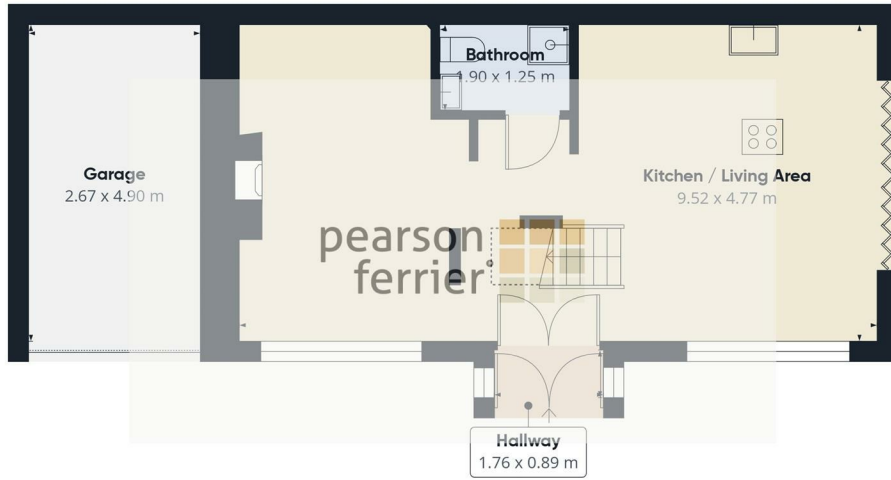

Floor 0



Floor 1

Approximate total area⁽¹⁾

104.4 m²

Reduced headroom

8.5 m²

(1) Excluding balconies and terraces

Reduced headroom

..... Below 1.5 m

Calculations reference the RICS IPMS 3C standard. Measurements are approximate and not to scale. This floor plan is intended for illustration only.

GIRAFFE360

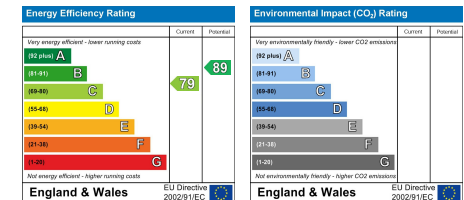

Bury Office
435/7 Walmersley Road, Bury, Lancashire, BL9 5EU
Telephone: 0161 764 4440
Fax: #
Email: bury@pearsonferrier.co.uk

www.pearsonferrier.co.uk



All statements contained in these particulars are for indicative purposes only and are made without responsibility on the part of Pearson Ferrier and the vendors of this property and are not to be relied on as statements or representations of fact. Potential purchasers should satisfy themselves by inspection or otherwise as to the accuracy of such details contained in these particulars.